

www.luxorfurn.com
www.hwilson.com

Parts List

Tools Required

- Rubber Mallet

NOTICE:

Leg lengths of leg **E** may be shorter than leg **F**

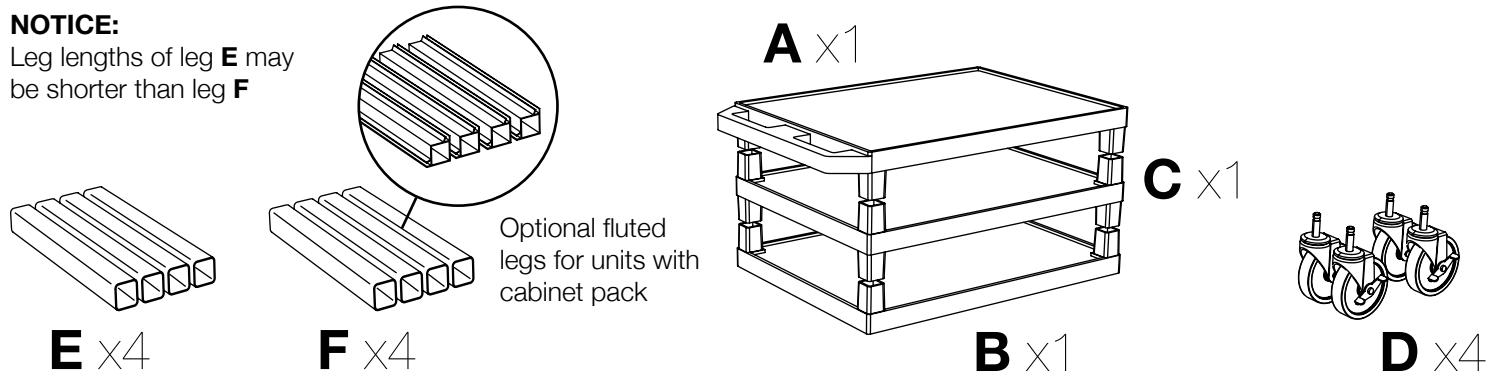

1

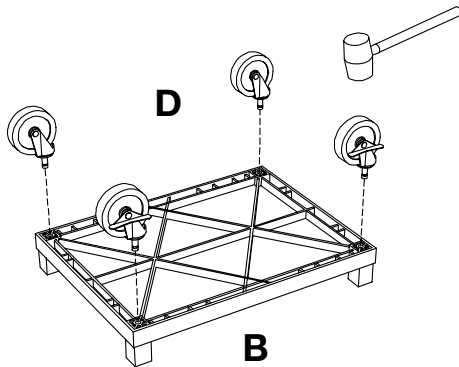

2

Install optional cabinet pack / pullout shelf / locking drawer assembly after step 1

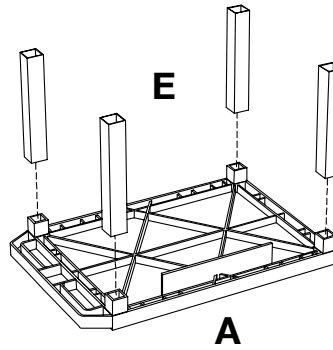

3

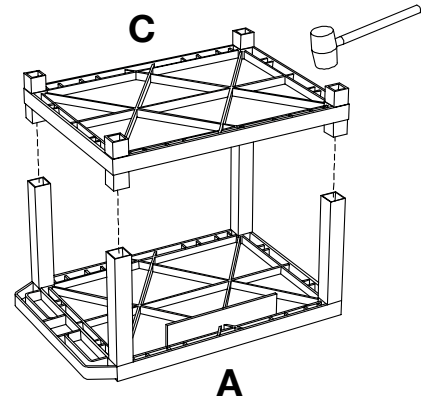

4

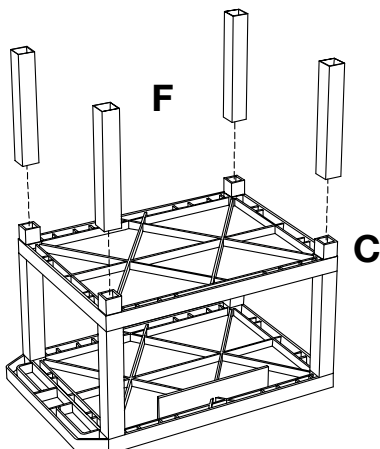

5

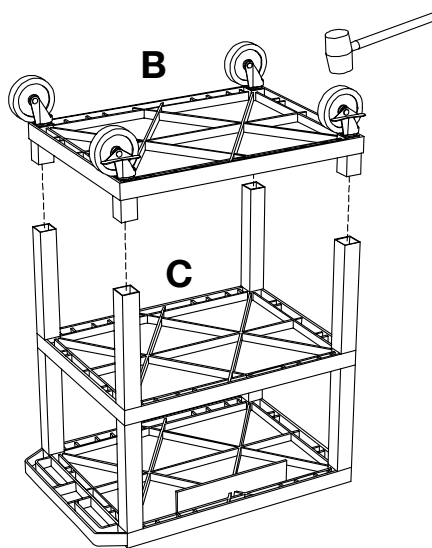

6

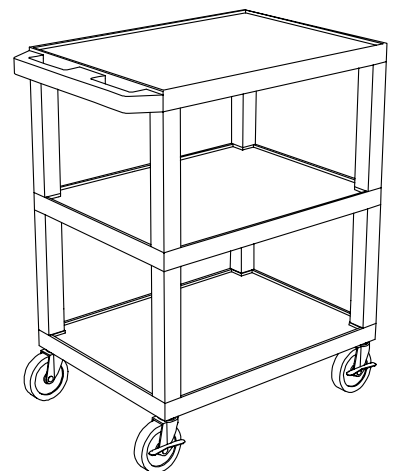

Parts List

Tuffy Cart

Tools Required

- Phillips Screwdriver

G x1

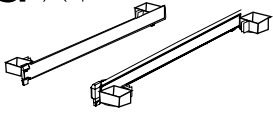

H x1



K x1



L x2



M x6

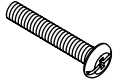

N x4

- 1** Lay the top shelf of your Tuffy cart upside down and install the four legs intended for this shelf.

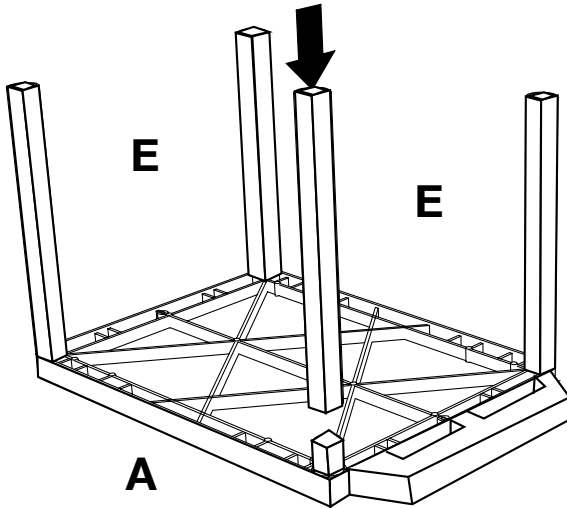

- 2** Slide and align runner **H** & **G** onto the legs and tighten screw **N** with a screwdriver.

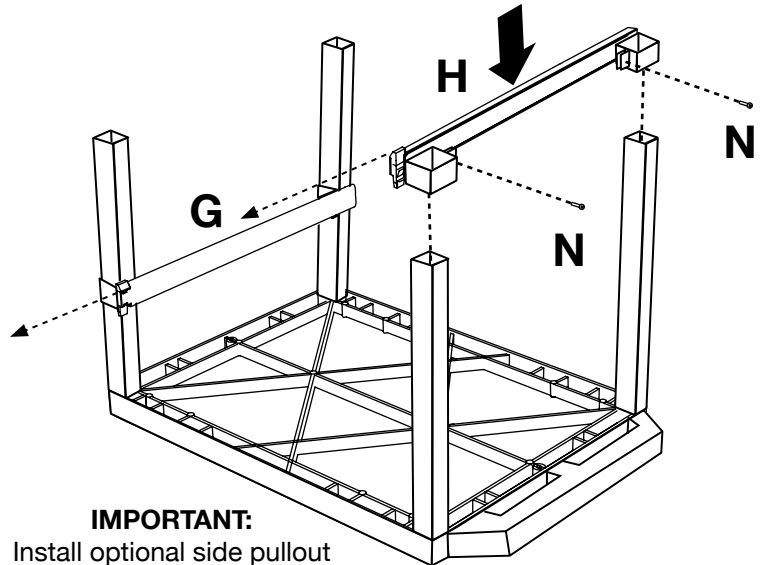

IMPORTANT:
Install optional side pullout shelf **AFTER** step 2

- 3** Take pullout shelf **K** and bracket **L** and screw together into the unfinished surface of shelf **K** with screw **M**.

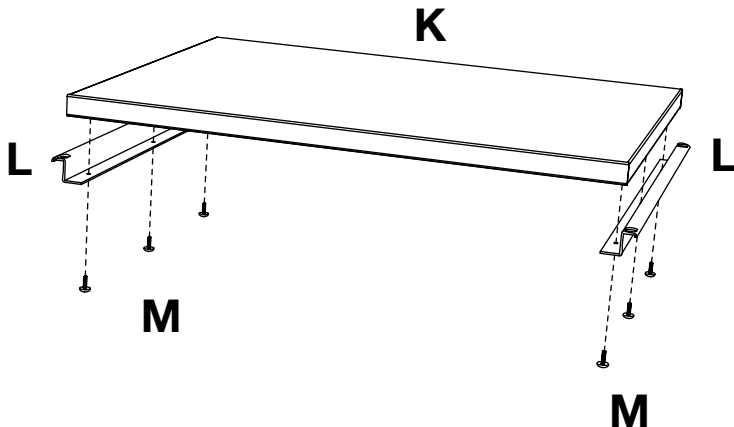

- 4** Mount pullout shelf **K** to runner **H** & **G** so that the edge of the shelf snaps into the runner hooks.

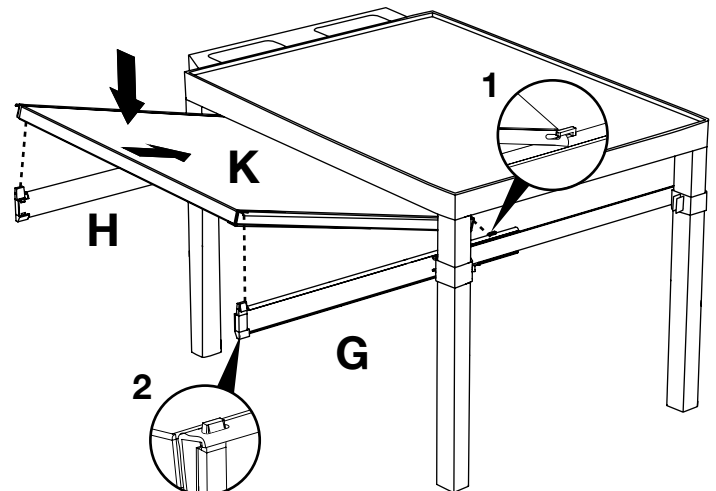

You have now completed your pullout shelf.

www.luxorfurn.com
www.hwilson.com

Parts List

Tools Required

- Phillips Screwdriver
- 13mm Socket Wrench
- Drill + 3/8" or 9mm Drill Bit (Not required on units with pre-drilled hole)

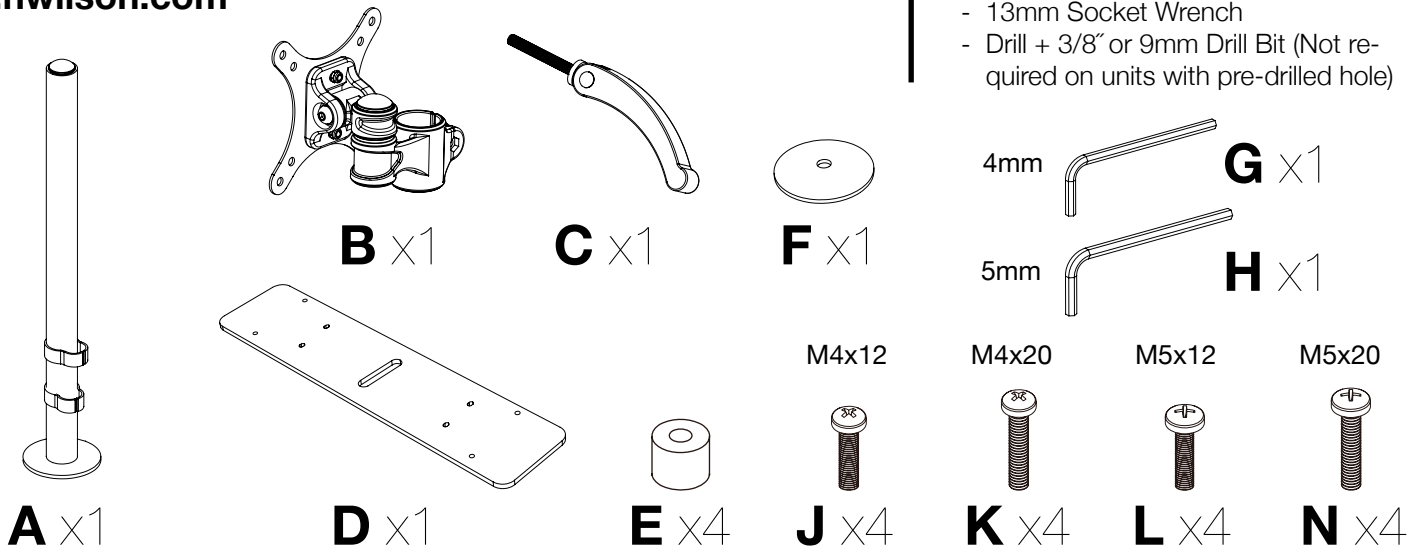

Self Install Instructions:

For plastic ribbed shelf drill into sections where the cross ribs intersect. For other surfaces make sure there is 3" x 12" of clearance for the mounting plate.

WARNING: Please follow the cautionary guidelines included with your drill.

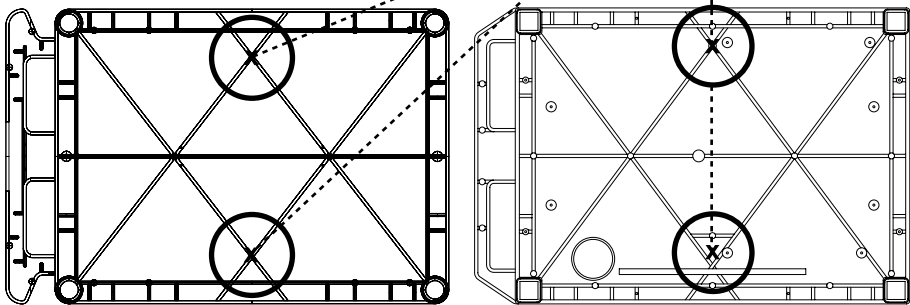

Bottom of Luxor Top Shelf

Bottom of H.Wilson Top Shelf

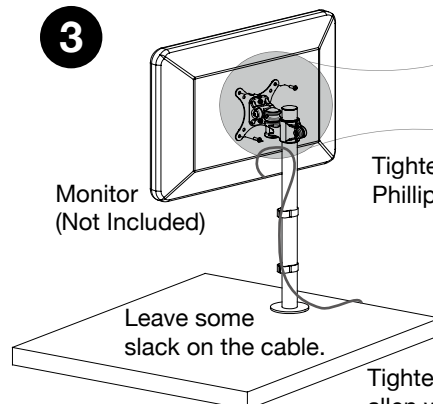
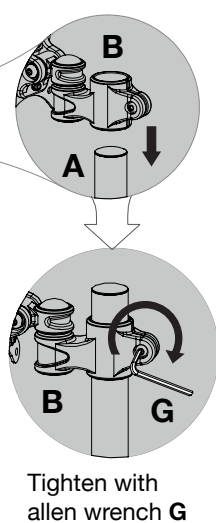
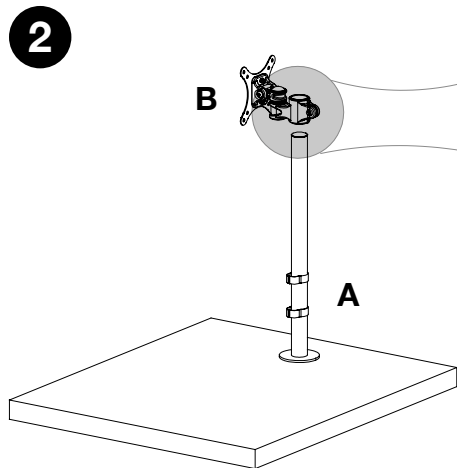
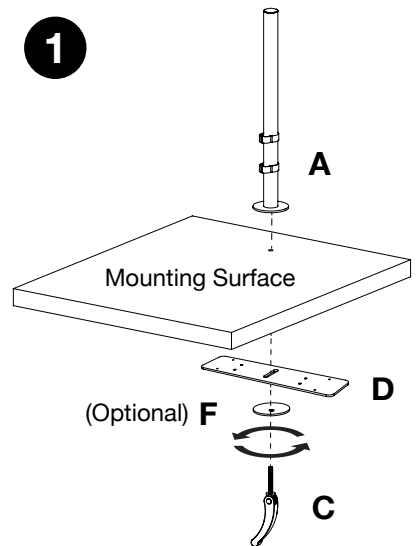

Insert spacers E on screens with counter sunk hole patterns

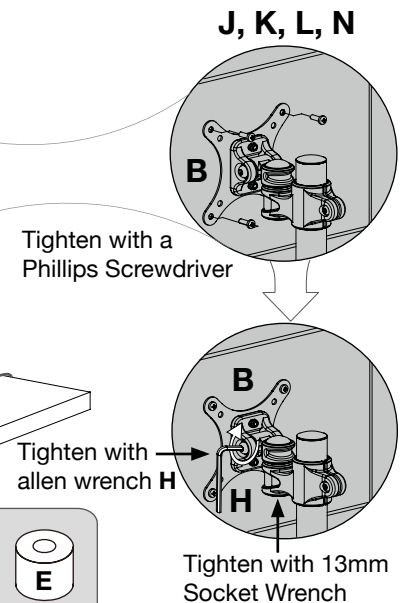

Parts List

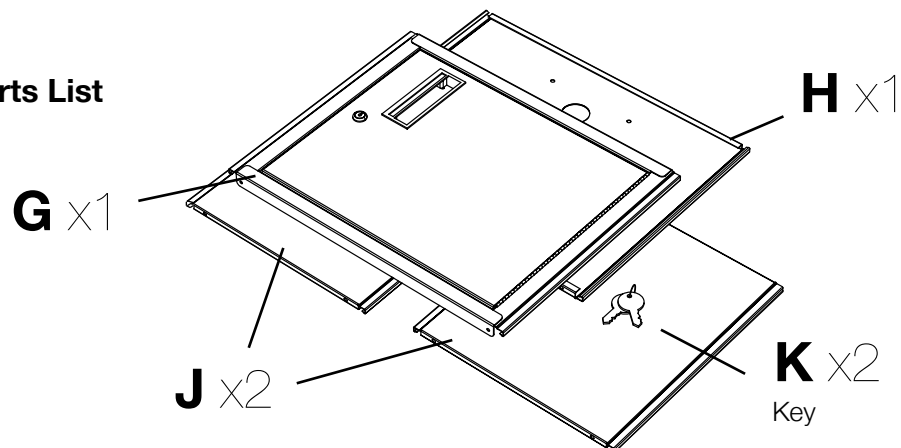

Tools Required

- Rubber Mallet

Tuffy Cart Cabinet Pack Instructions

Please consult your Tuffy cart base unit instructions before starting

1

IMPORTANT: Flip shelf B, and lock the 2 locking casters D before assembling the unit.

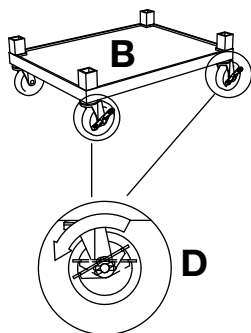

2

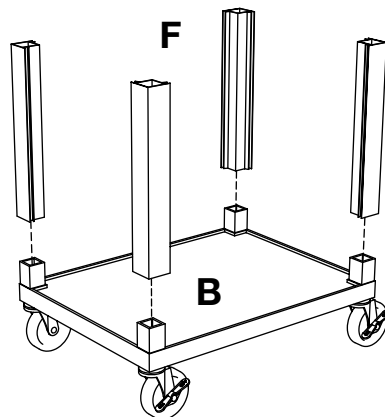

3

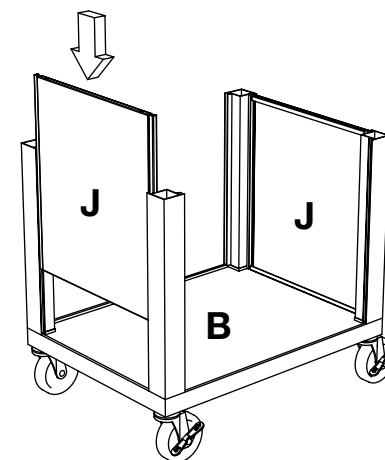

4

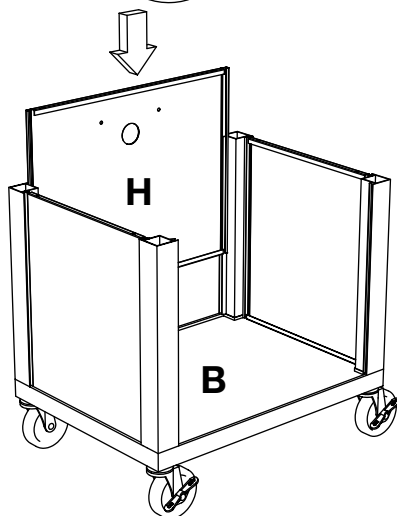

5

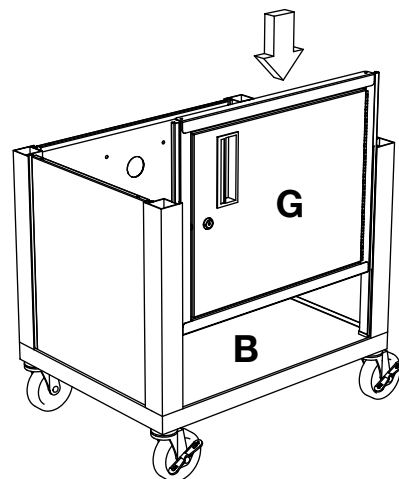

6

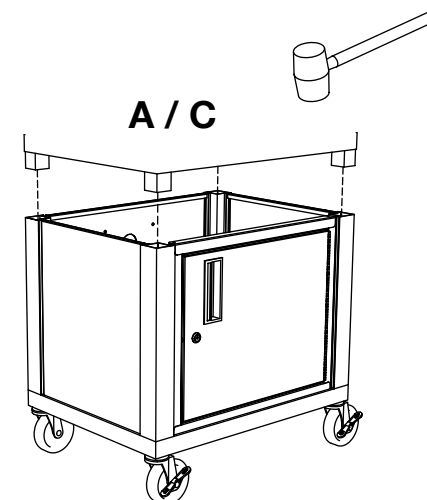

www.luxorfurn.com
www.hwilson.com

Electric Assembly Instructions

Number of outlets
may vary.

Parts List

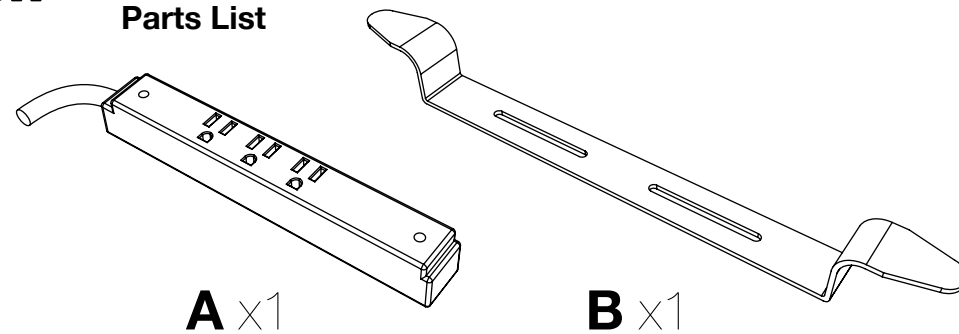

Tools Required

- Screwdriver

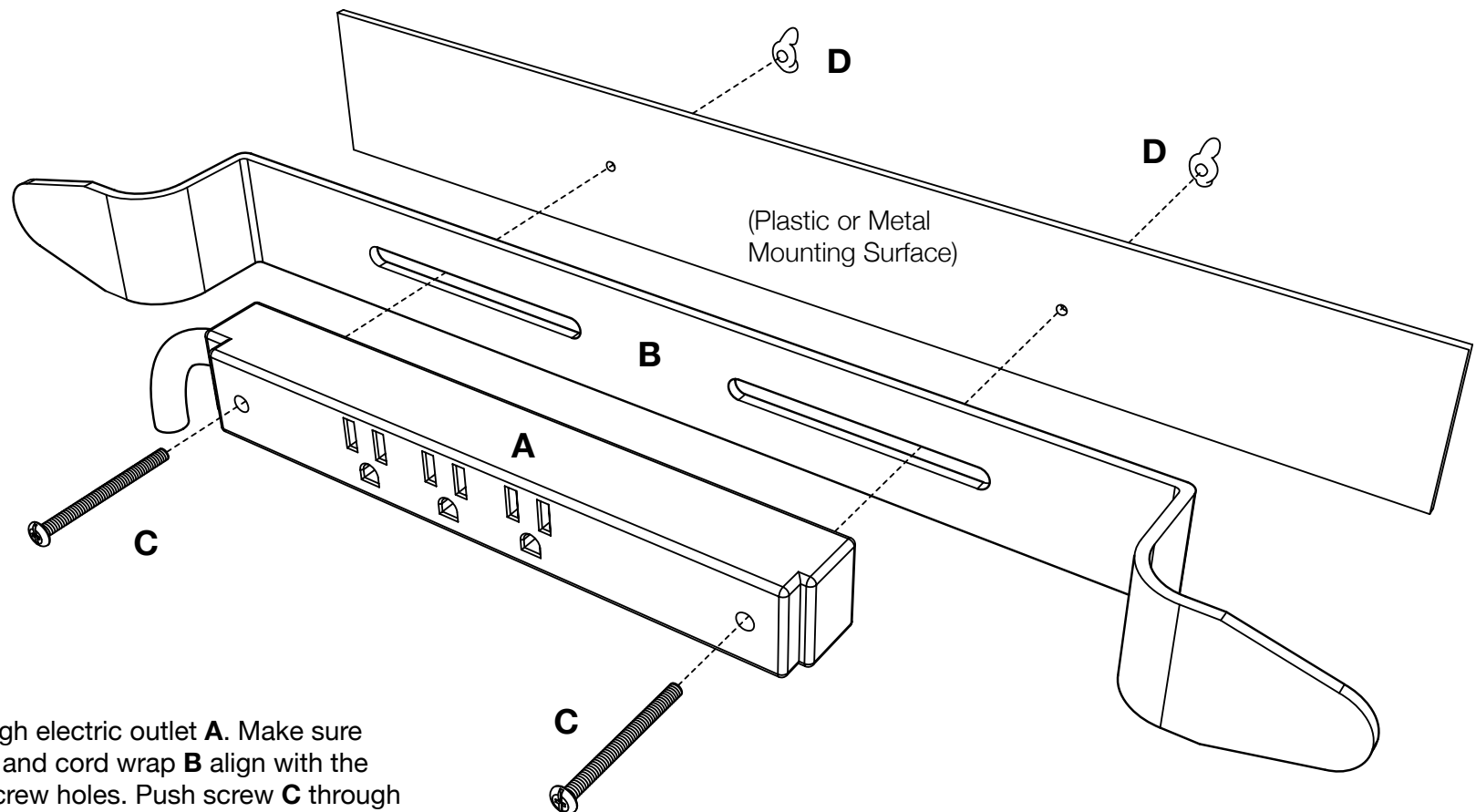
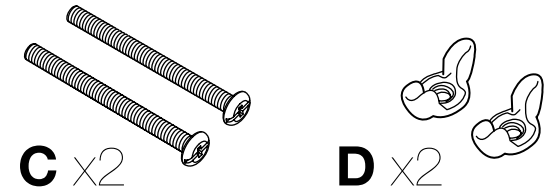

1

Push screw **C** through electric outlet **A**. Make sure the electric outlet **A** and cord wrap **B** align with the mounting surface screw holes. Push screw **C** through cord wrap **B** and the mounting surface screw holes. Use wing nut **D** and screwdriver to fasten.