



6/30/2006

VISIT THE LIFETIME WEB SITE:  
WWW.LIFETIME.COM

**\*\* Do Not Contact the Store \*\***  
***For Assistance, including missing or broken parts,***  
***Call Customer Service at:***  
***1 (800) 225-3865***

## 60" Shed Extension Kit w/ Two Windows MODEL #6426

ASSEMBLY  
INSTRUCTIONS AND  
OWNER'S MANUAL

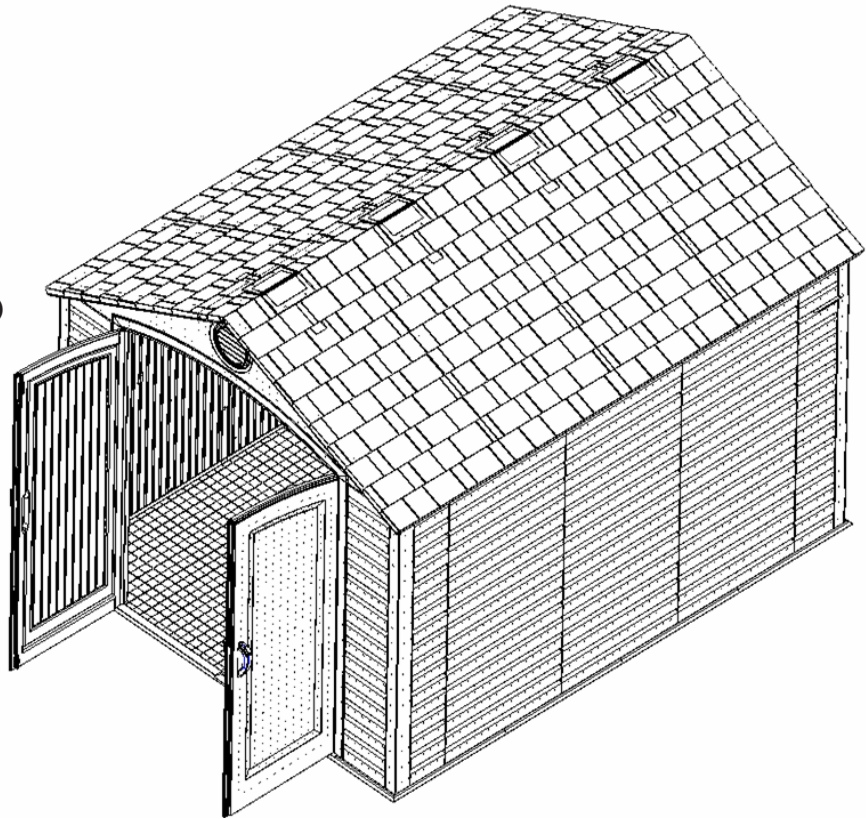

Save this instruction in the event that the manufacturer has to be contacted for replacement parts.

INSTRUCTION #1016067

**\*\*A MINIMUM OF TWO ADULTS ARE REQUIRED FOR ASSEMBLY\*\***

STOP!

## BEFORE BEGINNING ASSEMBLY

STOP!

Identify and inventory all parts using the checklist boxes on the Parts List. Keep the hardware bags and their contents separate. If any parts are missing, call our Customer Service Department.



## SAFETY INSTRUCTIONS



**Failure to follow these safety instructions may result in serious injury or property damage.** Proper and complete assembly, use and supervision is essential for proper operation and to reduce the risk of accident or injury. A high probability of serious injury exists if this display is not installed, maintained, or operated properly. • If using a ladder during assembly, use extreme caution. Follow all warnings and cautions on the ladder carefully. • 2 people are required for assembly. • Misuse could result in system failure. • If technical assistance is required, contact the manufacturer.  
*Most injuries are caused by misuse and/or failure to follow instructions.*

## PARTS LIST

AA	1007995	Center Roof Cap	2
AB	1007984	Gutter Channel	4
AC	1007977	Wall Support Channel	4
AD	1007988	Truss Channel	2
AE	1007996	Inner Roof Panel	4
AF	1007997	Wall Panel	2
AG	1009232	Skylight	2
AH	1007998	Window Wall Panel	2
AI	1007999	Window Frame C	4
AJ	1008000	Inner Floor Panel	4
AK	1008001	Roof Support Strip	8
AL	1013660	Window C	4
AM	1009156	Truss Support Strip	4
<b>Shed Parts Box [1016075]</b>			
<b>Window Hardware Bag [1011813]</b>			<b>2</b>
CA	BS05800	#10 x 3/4" Pan-Head Screw	5
CB	BS05900	#10 x 1/2" Pan Head Screw	16
CC	BW01300	#10 Washer	4
CD	BN01600	#10 Cap Nut	2
CE	1005984	#10 x .38" Flat Head Screw	2
CF	1005981	#10 x 1 1/4" Pan Head Screw	4
CG	1005982	#10 x 1/2" Pan Head Screw	6
SS	BS07500	1/4" x 5/8" Screw	4
CI	1008533	#10 x 5/16" Pan Head Screw	2
CJ	1009211	Window Stay Bracket	2
CK	1009212	Mounted Window Stay	2
CL	1009213	Sliding Window Stay	2
CM	1009214	Window Latch Bearing	4
CN	1009215	Window Latch	4
CO	1004592	Window Hinge	4
<b>Skylight Hardware Bag [1010047]</b>			<b>1</b>
LA	BW01200	#10-1" Fender Washer	13
LB	1010132	#10 x 5/8" Pan Head Screw	13
<b>Truss Extension Hardware Bag [1016074]</b>			<b>1</b>
FA	1009117	Floor Bracket	4
FB	300072	1/4" x 1 1/2" Hex Bolt	21
FC	BN00300	1/4" Cap Nut	21
FD	1012933	Center Gutter Connector	2
<b>Shed Screw Hardware Bag [1011135]</b>			<b>1</b>
SS	BS07500	1/4" x 5/8" Screw	118

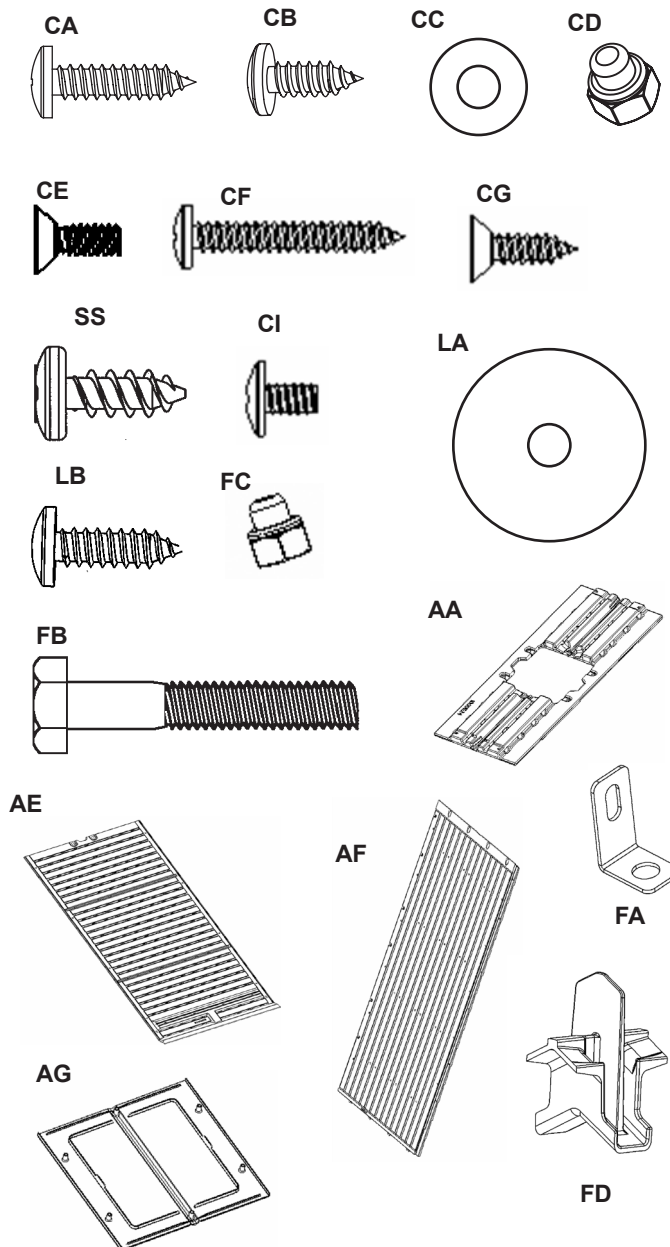

## HARDWARE IS ACTUAL SIZE

(unless otherwise indicated)

AH

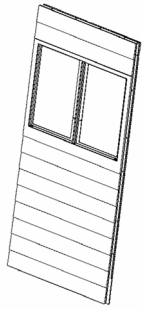

AI

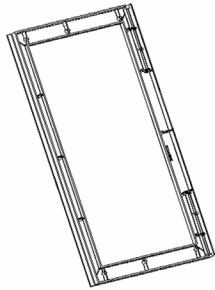

AJ

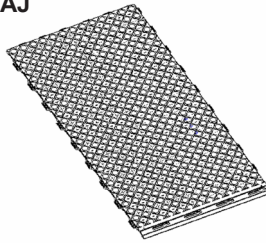

AK



AL

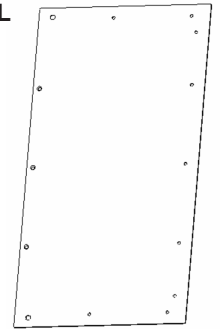

AM

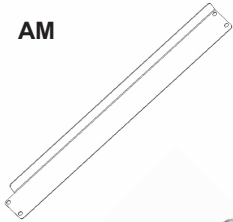

CJ

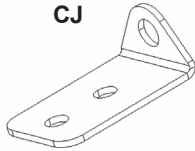

CK

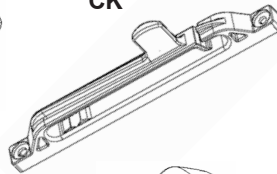

CL

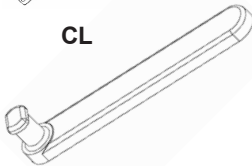

CM

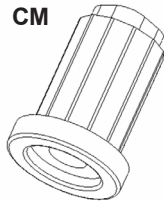

CN

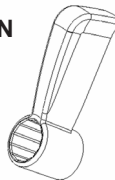

CO



AB



AC

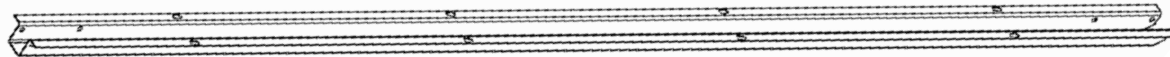

AD

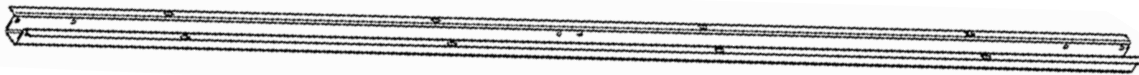

### Tools and Materials Required for Assembly (Not Included)

1. 7/16" Wrenches (2)
2. 3/8" Wrenches (2)
3. #2 Phillips screwdriver or  
Electric drill with Phillips head

### If you are Extending an Existing Shed

1. To obtain instructions for extending a shed that has previously been assembled, contact our Customer Service Department. If you have not yet assembled your shed, use the instructions on the following pages.

**To extend a previously assembled shed,  
Call Customer Service for Instructions:**

**1 (800) 225-3865**

## Add Extension Kit During Shed Assembly

1. Check contents of boxes and compare to parts listed on the Parts List.
2. Follow instructions that came with your shed, but when you come to the following sections of your Owner's Manual assemble the additional floor, wall, window and truss parts that are included in this kit.

### Site Selection

- a. Add 60" to the site or platform length. (width will remain the same). This may require the use of additional lumber or other materials.

### Assemble Floor

- a. Follow Owner's Manual instructions to install the additional Inner Floor Panels (AE) included in this kit, along with those that came with your shed.

### Assemble Wall (Right or Left)

- a. Add the two Wall Panels (AF) and two Window Wall Panels (AH) from this kit to both sides of the shed. Remember that Window Wall Panels can be inserted into any position on either side of the shed.

### Assemble Windows

- a. Follow Owner's Manual instructions to assemble the windows in the Window Wall Panels included in this kit, along with those that came with your shed.

### Assemble Truss Frames

- a. Follow Owner's Manual instructions to assemble the Truss Frames included in this kit, along with those that came with your shed.

### Install Truss Assemblies

- a. Follow Owner's Manual instructions to assemble the Truss Frames included in this kit, along with those that came with your shed.

### Install Center Roof Sections

- a. Follow Owner's Manual instructions to install the additional Inner Roof Panels, Roof Caps and Skylights included in this kit, along with those that came with your shed.