



NEW! TENA Dry Comfort™ Briefs

The curve-shaped design helps ensure a body-close fit

New TENA Dry Comfort™ Briefs with CurvDefence™ have a new curve-shaped design and curved leg elastics to help ensure a comfortable, body-close fit. Patented DuoLock® Core Technology helps deliver more absorption capacity where it's needed most for optimal product performance. The EzFasten® fastening system helps make product application comfortable for the wearer, helps provide a secure fit, and the Ultra Back Panels provide enhanced coverage. Meets NAFC Standard Requirements.



CurvDefence™

Curve-shaped design helps ensure a body-close fit

Ultra back panel

Provides enhanced coverage



DuoLock® Core

Wicks away and locks in moisture away from skin

EzFasten® fastening system

Helps provide a secure and comfortable fit



Wetness indicator

Indicates the brief may have been soiled and needs to be checked



| Product Name | Absorbency | Order # | Hip Size | Color | Case | Format |
|-----------------------------|------------|---------|-----------|-------|------|--------|
| TENA Dry Comfort™ Briefs M | ●●●●● | 67420 | 32" – 44" | White | 80 | 4/20 |
| TENA Dry Comfort™ Briefs L | ●●●●● | 67430 | 40" – 56" | Blue | 80 | 4/20 |
| TENA Dry Comfort™ Briefs XL | ●●●●● | 67440 | 52" – 62" | Beige | 80 | 4/20 |

TENA Dry Comfort™ Briefs Fitting Guide

Lying down

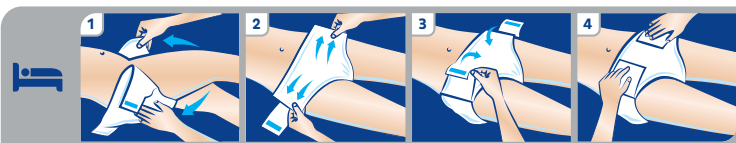

Standing up

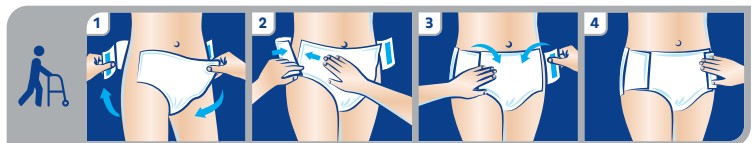

BETTER CARE FOR EVERYONE

Contact us for further information



1.866.722.6659



essityorders@essity.com

TENA, DuoLock and EzFasten are a registered trademarks of Essity Hygiene and Health, AB. TENA Dry Comfort and CurvDefence are trademarks of Essity Hygiene and Health, AB.
©2023 Essity HMS North America Inc. J23 65066 RN